

19TH ANNUAL CONFERENCE ON
CRIMES AGAINST WOMEN

MAY 20-23, 2024

SHERATON HOTEL | DALLAS, TEXAS

WELCOME TO THE 19TH ANNUAL

CONFERENCE ON CRIMES AGAINST WOMEN



I am honored to welcome you to the 19th annual Conference on Crimes Against Women (CCAW). In partnership with the Dallas Police, Genesis is committed to moving the needle on the way we all respond to crimes perpetrated against women. What began as a 2-day conference of 400 people has grown to become the largest conference of its kind in the country. Over 2,500 attendees from all 50 states and 8 foreign countries have convened to learn best practices to hold perpetrators accountable while providing justice for victims.

For you who have previously attended the national Conference on Crimes Against Women, WELCOME BACK! If you are a first-time attendee, you are in for an amazing four days. There is nothing quite like the energy that comes from a ballroom of thousands of practitioners all coming together with one shared goal – to learn and equip new tools and skills for working with and bringing justice to women who have experienced gender-based violence.

For 19 years, the Conference on Crimes Against Women has provided best practices and resources to system professionals to assist in their role of helping end violence against women. CCAW has been recognized as the nation's leading training resource on these types of crimes. And, since opening our new non-residential center, Genesis has launched the National Training Center on Crimes Against Women. All CCAW attendees will be receiving information about ongoing year-round trainings as we continue to support you in your efforts to end violence against women.

Thank you for continuing to trust us to provide the most cutting-edge, timely education in the field. And thank you for what you do day in and day out. Please know you make a difference. YOU ARE OUR HEROES!

MISSION OF CCAW The mission of the Conference on Crimes Against Women (CCAW) is to provide a national platform to disseminate the highest level of training, information, and strategies to professionals who are responders and advocates to victims of the many and varied forms of crimes against women including domestic violence, human trafficking, sexual assault, and strangulation.

Jan Langbein, Chief Executive Officer
Genesis Women's Shelter & Support
& Conference on Crimes Against Women

CONFERENCE PRESENTED BY



GENESIS WOMEN'S SHELTER & SUPPORT provides safety, shelter, and support for women who have experienced domestic violence and raises awareness regarding its cause, prevalence, and impact.

24-hour helpline: 214.946.HELP (4357) | www.genesisshelter.org

Help is free and confidential



THE DALLAS POLICE DEPARTMENT is dedicated to protecting all Dallas citizens from crimes through its prevention, patrol, and investigative activities. With respect to the victimization of women, the Department has deployed significant resources to effectively investigate the full range of crimes that are committed against women. While all personnel share the responsibility to combat these crimes, the Department has specialized units that have the primary investigative responsibility for the investigation of domestic violence, protective order violations, stalking, sexual assault, registered sex offenders, trafficking, and homicide.

CCAW PROGRAMS

Check out the programs that Conference on Crimes Against Women has to offer!



The Conference on Crimes Against Women (CCAW) launched the National Training Center on Crimes Against Women (NTCCAW) in 2023. NTCCAW allows CCAW to expand to year-round programming, broadening the ability to dive deeper into discipline-specific topics and increasing the opportunity to reach other disciplines such as healthcare, faith communities, and higher education.

The National Training Center (NTC) serves as an integral part of CCAW's mission to provide a national forum to disseminate the highest level of training. This is accomplished by providing progressive and advanced training from our array of subject matter experts that we have cultivated over the last two decades through the annual conference. NTCCAW offers a space for our state and national partner(s) to host events and trainings.

Visit www.trainingcaw.org to learn more about the NTC and see upcoming training opportunities.



The Institute for Coordinated Community Response (ICCR) works alongside rural communities to improve their collaborative, systemic responses to domestic violence. Criminal justice practitioners from a rural community review current practices, learn from experts, and collaboratively implement changes to begin establishing an effective, sustainable Coordinated Community Response (CCR). This also includes a robust program comprised of quarterly in-person trainings hosted in a rural community.

In addition, ICCR provides training focused around the unique needs of rural communities on a national level. This is accomplished by providing free e-courses, virtual roll call trainings, monthly webinars, and a two-day virtual conference; Collaborative Responses to Domestic Violence in Rural Communities.

Since its inception in 2018, ICCR has worked solely with counties throughout Texas, however in 2023 ICCR was awarded funding from the Office of Violence Against Women (OVW) to expand its work to rural communities throughout the United States.

Visit www.instituteccr.org to learn more about ICCR and online training opportunities.



The Podcast on Crimes Against Women serves as an extension of the information and topics presented at the annual Conference, providing in-depth dialogue, fresh perspectives, and relevant updates by experts in the fields of victim advocacy, criminal justice, medicine, and more. The podcast creates a space to engage and educate community members on the issue of violence against women, how it impacts our daily lives, and how we can work together to create lasting cultural and systemic change.

Visit www.conferencecaw.org/podcast to listen to all five seasons of the Podcast on Crimes Against Women, or subscribe to the podcast on your favorite platform.

Follow us on social media for up-to-date information on each of these programs!



OPENING PLENARY SPEAKERS

MONDAY, MAY 20TH | LONE STAR BALLROOM

This unique keynote conversation will feature Tony Porter, CEO, and Kimya Motley, CCO of A Call to Men. Through an interactive discussion, Kimya will share her story as a survivor of domestic and gun violence. Tony will share the role men play in challenging societal norms and dismantling harmful behaviors, and how men can use their influence and platform to be a significant part of the solution to preventing violence against women and girls.

TONY PORTER



&

KIMYA MOTLEY



DOWNLOAD THE APP

Get all the conference information you need and instant updates.

ONLY ON THE APP:

- View full session descriptions and speaker bios
- Create your personal agenda
- Download session handouts
- Get important updates and exciting offers
- Complete session surveys
- Network with other attendees on the social feed



SCAN TO
**DOWNLOAD
THE APP!**

HOW TO GET THE APP:

- Search Apple Store or Google Play for "CCAW" and download
- Once in the app, click the download button and then press the arrow to enter into the event
- Log in with your credentials and enter the verification code sent to your email address and/or phone number

Visit the Help Desk with any questions. We are happy to help!

ACCREDITATION

PLEASE NOTE: Credit for CEUs is only awarded to those who registered for CCAW.

AMERICAN BOARD OF MEDICOLEGAL DEATH INVESTIGATORS (ABMDI)

- Up to 16 hours of CE for Medical Examiners, Coroners, and Death Investigators

AMERICAN PROBATION & PAROLE (APPA)

- Up to 16 hours of CE for APPA Contact Hours

CONTINUING NURSING EDUCATION (CNE)

- Up to 24 hours of CE for Nursing

This nursing continuing professional development activity was approved by the Emergency Nurses Association, an accredited approver by the American Nurses Credentialing Center's Commission on Accreditation.

INTERNATIONAL ACADEMIES OF EMERGENCY DISPATCH (IAED)

- Up to 16 Continuing Dispatch Education (CDE) hours may be available for IAED-certified Emergency Dispatchers in the Workshops and Seminars category

Hours are self-reported through the IAED Member Portal.

NATIONAL ORGANIZATION FOR VICTIM ASSISTANCE (NOVA)

- Up to 24 hours of CE for D-SAAP (Dept. of Defense Sexual Assault Advocate Certification Program)
- Up to 24 hours of CE for NACP (National Advocate Credentialing Program)

Applicants will be required to provide a certificate of completion or transcript that indicates the total CE hours earned and if CE hours are planned to be used toward a NACP specialty designation, applicants will need to indicate which workshops were attended.

STATE BAR OF TEXAS/TEXAS CENTER FOR JUDICIARY (MCLE)

- Up to a maximum of 24 participatory hours of CLE

Hours are self-reported through the Texas Bar portal (Course #174230769).

TEXAS COMMISSION ON LAW ENFORCEMENT (TCOLE)

- Up to 24 hours of TCOLE-eligible sessions

Attendees requiring TCOLE credit must self-report through their agency or department. CCAW is not able to submit on their behalf. Certificates must be submitted per TCOLE requirement for training. Please be aware of your TCOLE training cycle. Questions should be directed to the attendee's training division or TCOLE. Your total hours will be listed on the certificate. Hours are based on evaluations completed and submitted for sessions attended.

TEXAS STATE BOARD OF EXAMINERS OF MARRIAGE & FAMILY THERAPISTS (LMFT)

TEXAS STATE BOARD OF EXAMINERS OF PROFESSIONAL COUNSELING (LPC)

TEXAS STATE BOARD OF SOCIAL WORK EXAMINERS (LMSW & LCSW)

- Up to 24 hours of CEU credit may be available for Clinical Professionals

CCAW and Genesis Women's Shelter & Support complies with Continuing Education Requirements designated by the Texas State Board of Examiners of Professional Counselors, the Texas State Board of Social Worker Examiners, and the Texas State Board of Examiners of Marriage and Family Therapists. We encourage licensees to determine which courses contain topics related to their specific field of work.

OUT-OF-STATE ATTENDEES

- Training credit may be awarded at your state's licensing agency's discretion.
- Your licensing agency can contact the CCAW team at info@conferencecaw.org with any questions regarding your attendance.

HOW TO RECEIVE CREDIT

- Your certificate will include provider numbers for this Conference.
- To receive accreditation, each attendee must report their attendance to their individual reporting agency. It is up to each reporting agency to accept eligible hours and report those hours. CCAW Staff will be monitoring each workshop for attendance accuracy in case of an audit. Please note: completion of each session survey is required.
- Attendees can track their attendance and continuing education credits at any time during CCAW on the Conference App. Attendees must scan into sessions and complete the session survey to be eligible for credit.

NOTE: Only ONE certificate will be sent after completion of the overall survey, and will contain the name of the attendee who registered for CCAW. No certificates will be given to attendees who did not register for CCAW.

2024 IGNITE AWARD WINNER



ON THE ROAD LENDING

On the Road Lending is a 501(c)3 nonprofit organization founded in 2013 that provides vehicle selection assistance and long-term financial mentoring to address a misunderstood, but substantial problem—providing a way for low-income individuals and families to overcome transportation barriers so they can get to work, lead healthier lives, and avoid predatory lending. On the Road Lending helps people improve their credit and purchase fuel-efficient, reliable cars, financing them through their sister private-equity loan fund with a low-cost loan.

Lack of reliable transportation is one of the reasons people lose their jobs. On the Road Lending helps people overcome this risk by finding them reliable cars that are affordable, under warranty, and fuel-efficient so they never have unforeseen, expensive car repair bills. They work with clients to build financial capability and then arrange an affordable loan. They stay with their clients for the life of the loan—usually five or more years—providing financial mentorship and support.

"I've really seen some amazing things since I started this company. Without fail, I have seen tears each time I deliver a car. These tears are tears of joy, relief, and gratitude. These are families who are amazed that someone would take a chance on them. I have seen people get raises and promotions because they could get to work on time. I have seen people whose children could go to better schools because their parents could get them there. I have seen families achieve economic mobility and better health. It is more than freedom of time, although that is critically important. I have learned that these families—my friends—love their cars in the same way I love mine."

The poster features a dark, textured background with a central red sunburst shape. The words 'HOWDY HOUR' are written in large, white, distressed, block letters across the sunburst. Above the sunburst, the text 'JOIN US FOR OUR ANNUAL HOWDY HOUR' is on the left, and 'MAY 20, 2024 | 5:30 - 7:30 P.M.' is on the right. The background includes silhouettes of cacti, a sombrero on a table, and birds flying. At the bottom, the text 'CASINO ★ DJ ★ NACHO BAR ★ RAFFLE ★ CASH BAR' is displayed in a bold, sans-serif font with stars between the items.

JOIN US FOR OUR ANNUAL HOWDY HOUR

MAY 20, 2024 | 5:30 - 7:30 P.M.

HOWDY HOUR

CASINO ★ DJ ★ NACHO BAR ★ RAFFLE ★ CASH BAR

MONDAY MAY 20, 2024

7:00-8:00am

REGISTRATION & CONTINENTAL BREAKFAST (SEATING AVAILABLE IN GRAND HALL) - PRECONVENE AREA

8:00-8:30am

TRIBAL PROCESSIONAL | SEE BELOW FOR DETAILS

8:30am-9:30am

OPENING PLENARY: Tony Porter with Kimya Motley LONE STAR BALLROOM

LONE STAR A1

LONE STAR A2

LONE STAR A3/A4

LONE STAR B

LONE STAR C1

LONE STAR C2

LONE STAR C3/C4

DALLAS A2/A3

DALLAS B

9:30am-10:00am

BREAK

10:00am-11:30am

| | | | | | | | | |
|---|--|---|--|---|--|--|--|---|
| <p>Overcoming Harmful Jury Instructions & Obtaining a Conviction</p> <p>★</p> <p>Kathryn Marsh</p> | <p>Identifying the Missing Link: Serial Perpetrators & Survivor Coordination on College Campuses</p> <p>+</p> <p>Tracy DeTomasi</p> | <p>Missed & Misdiagnosed Femicides: Closing the Gaps Amongst Systems (Pt. 1)</p> <p>★ +</p> <p>Andrea Zaferes Butch Hendrick Maria McCarthy Kenneth Rosgen</p> | <p>CASE STUDY: Free Too Long: The 15 Year Fight to Stop a Serial Rapist</p> <p>★ + 🔍</p> <p>Kim D'Avignon Jacklyn Donalson Madeline Jones</p> | <p>In It Together! Strategies for Impactful Community Engagement & Team Building</p> <p>Dorothy Enriquez</p> | <p>Jury Selection: First Tackle the Myth & Bias, Then Select the Right Jurors</p> <p>★</p> <p>Julie Germann</p> | <p>Financial Violations Targeting Elders: FBI Investigations & Victim Support</p> <p>★</p> <p>Caitlyn Neff Melissa Stroop</p> | <p>Law Enforcement & Multi-Disciplinary Team Approaches</p> <p>Dan Rincon</p> | <p>Game Day Prep: Interrogating Homicide Suspects</p> <p>Mike Krapfl Scott Reger</p> |
|---|--|---|--|---|--|--|--|---|

11:30am-12:00pm

BREAK

12:00pm-1:30pm

| | | | | | | | | |
|---|---|---|--|---|---|--|---|--|
| <p>Why Every Piece of the Puzzle Matters: Coordinated Community Response in Intimate Partner Violence Cases</p> <p>★</p> <p>Carolina Frane Sandra Campanella</p> | <p>The Forgotten First Responder: Addressing Vicarious Trauma & Burnout in 9-1-1 Call Takers</p> <p>Jennett Sullivan Katherine Manners</p> | <p>Missed & Misdiagnosed Femicides: Closing the Gaps Amongst Systems (Pt. 2)</p> <p>★ +</p> <p>Andrea Zaferes Butch Hendrick Maria McCarthy Kenneth Rosgen</p> | <p>Targeted Trauma: Exploring the Intersection of IPV, Firearms, & the Black Community</p> <p>★</p> <p>Millcent Shaw Phipps Sarah Henry</p> | <p>Advocating for Indigenous Survivors: Strategies & Framework for Tribal Advocates</p> <p>Nicole Matthews Ingrid Anderson</p> | <p>Engaging Men: Gender-Based Violence Prevention & Intervention</p> <p>Jules Perkél</p> | <p>A Holistic Toolkit: Equipping Clinicians with Integrative Trauma Treatment Strategies</p> <p>+</p> <p>Melissa Harrison</p> | <p>Vital Signs: Enhancing the Healthcare Provider's Response to Stalking</p> <p>+</p> <p>Jennifer Landhuis</p> | <p>Tools for the Toolbelt: Perspectives Related to Autism and the First Responder</p> <p>+</p> <p>Jamie Owens</p> |
|---|---|---|--|---|---|--|---|--|

1:30-2:00pm

BREAK

2:00-3:30pm

| | | | | | | | | |
|---|---|--|---|---|--|---|--|---|
| <p>DV RISC: Discussing Foundational Building Blocks for IPV Risk Assessment Implementation</p> <p>★</p> <p>Michelle Toledo Cainas Raysa Guerrero Sarah Henry</p> | <p>The Reverberation of IPV: Exploring the Lethality & Safety for Both Victims & Survivors</p> <p>★</p> <p>Dave Thomas</p> | <p>CASE STUDY: Behind Closed Doors: The Murder of a Military Spouse</p> <p>★ 🔍</p> <p>Jennifer Swartz</p> | <p>The OTHER Responder: Joint 911 Response Between Emergency Medical Services & Law Enforcement</p> <p>+</p> <p>Zita Konik Naïla Franches Robert Frechette</p> | <p>Examining the Intersections of Intimate Partner & Community Violence w/Firearms</p> <p>★</p> <p>Shelli Egger Amber Goodwin Alicia Nichols</p> | <p>Overcoming the Rough Sex & Consent Defenses</p> <p>★</p> <p>Kelsey McKay Scott Hampton</p> | <p>CASE STUDY: Silenced Voices: A Predator's Operation of Violence, Opioids, & Sex Trafficking</p> <p>★ + 🔍</p> <p>Jennifer Rausch Travis Aaron Heather Hill</p> | <p>The Strategic Use of Experts: Exploring the Impact of Civil Issues within IPV Criminal Cases</p> <p>★</p> <p>Margaret Bassett Jeana Lungwitz</p> | <p>Vinegar or Honey? Exploring the Benefits of Empathy-based Interrogation (Pt. 1)</p> <p>★</p> <p>Nancy Oglesby Mark MacKizer Mike Milnor</p> |
|---|---|--|---|---|--|---|--|---|

3:30-4:00pm

BREAK

4:00-5:30pm

| | | | | | | | | |
|---|--|--|--|---|---|---|---|---|
| <p>Maximizing Offender Accountability: Probation & Parole, Polygraphs, & Offender Treatment Programs</p> <p>Misti Youngquist Victor Bibilonisambolin Scott Hampton</p> | <p>Optimizing Accountability: Strategies on Seeking Federal Prosecution in Cyberstalking & DV Cases</p> <p>★</p> <p>Callie Woolam Keith Quigley</p> | <p>CASE STUDY: No Diamond in the Rough: The Capture & Conviction of Billy Chemirmir</p> <p>★ 🔍</p> <p>Glen Fitzmartin</p> | <p>Traumatic Grief: Exploring the Complexities of Grief Responses</p> <p>+</p> <p>Kiva Harper</p> | <p>Playing Nice in the Sandbox: Coordinating Accountability & Safety in Campus Stalking Cases</p> <p>★</p> <p>Jennifer Landhuis Josh Bronson</p> | <p>Injuries, Ambush, & Fatality: Assessing Threats to First Responders of Domestic Violence</p> <p>Mark Wynn</p> | <p>Strengthening Federal & Local Partnerships to Address the Deadly Intersection of DV & Firearms</p> <p>★</p> <p>Eileen Husselbaugh Linda Phan Kristy Peoples Linda Phan Angela Vandergrift</p> | <p>Voices Unheard: Witness Intimidation's Silent Grip</p> <p>★</p> <p>John Guard</p> | <p>Vinegar or Honey? Exploring the Benefits of Empathy-based Interrogation (Pt. 2)</p> <p>★</p> <p>Nancy Oglesby Mark MacKizer Mike Milnor</p> |
|---|--|--|--|---|---|---|---|---|



MMIW TEXAS REMARIATE RED DRESS PROCESSIONAL

The RED DRESS Processional honors the women who have been lost due to violence. The dress MMIW Texas Rematriate leads showcases the color red, a color known to be sacred in many

tribes. It is believed to transcend the physical world and call to those in the spirit world. During the processional, it is calling attention to those who have been missing or murdered.

★ MCLE ELIGIBLE

+ CNE ELIGIBLE

🔍 CASE STUDY

👤 INTERACTIVE

💻 COMPUTER LAB

🔄 REPEAT

*RESTRICTION - SEE MOBILE APP FOR MORE INFORMATION

OPENING PLENARY: Tony Porter with Kimya Motley LONE STAR BALLROOM

SCHEDULE

DALLAS C DALLAS D1 DALLAS D2/D3 SAN ANTONIO A HOUSTON A HOUSTON B HOUSTON C STATE ROOM 1 SAN ANTONIO B

9:30am-10:00am

BREAK

10:00am-11:30am

| | | | | | | | | | |
|---|--|--|--|---|---|---|--|---|--|
| <p>The Consent Continuum: Navigating Yes, No, & Everything In Between</p> <p>★ +</p> <p>Kristin Daley Kenny Smith</p> | | <p>Expanding the Horizon: Exploring Perspectives Beyond Trauma-Informed Care</p> <p>Ruth Guerreiro</p> | <p>Advancing Justice with Forensic Genetic Genealogy</p> <p>+</p> <p>Patti Powers Ashley Rodriguez</p> | <p>Coercive Love: Intimate Partner Sex Trafficking</p> <p>+</p> <p>Jane Anderson Miiko Anderson</p> | <p>Lonely at the "Top:" Dispelling "Bottom Girl" Myths & Enhancing Advocacy for Sex Trafficking Victims</p> <p>Shamere McKenzie</p> | <p>Assuring an Appropriate Response When There is No SANE in Sight</p> <p>+</p> <p>Laci Smith</p> | | <p>SEARCH: Data in Data: Finding File Metadata and Using it in Investigations</p> <p>🖥️</p> <p>John Trenary Eric Jollymore Christopher Dale</p> | |
|---|--|--|--|---|---|---|--|---|--|

11:30am-12:00pm

BREAK

12:00pm-1:30pm

| | | | | | | | | | |
|--|--|---|---|--|--|--|--|--|--|
| <p>Abuse in Later Life on the Radar: Funding a Collaborative Approach for the Support of Older Survivors</p> <p>+</p> <p>Victoria Ferguson-Young Kristin Burki</p> | <p>Claim Your Power! Empowerment-based Self-Defense Education</p> <p>👤</p> <p>Nicole Snell</p> | <p>Motivational Interviewing: Evidenced-based Conversation for Change</p> <p>Misti Youngquist</p> | <p>Counterman vs. Colorado: We Got This! Examining Stalking Statutes</p> <p>★</p> <p>Jonathan Kurland</p> | <p>Freedom is Attainable: Substance Abuse & Recovery for Sex Trafficking Survivors</p> <p>★ +</p> <p>Lacy Montgomery</p> | <p>Meeting the Need of the Lack of Black SANE Nurses-Fayetteville SANE Program</p> <p>+</p> <p>Sharita Godwin Beth Andrews</p> | <p>The Perfect Plan: How Traffickers use Forced Criminality to Escape Accountability</p> <p>★ +</p> <p>Jane Anderson Miiko Anderson Shamere McKenzie</p> | <p>The VINELink.com Experience: Delivering Resources to All Victims</p> <p>★</p> <p>Karen Adams Cassie Drochelmann</p> | | |
|--|--|---|---|--|--|--|--|--|--|

1:30-2:00pm

BREAK

2:00-3:30pm

| | | | | | | | | | |
|---|--|--|---|--|--|---|---|--|---|
| <p>Balancing the Scales: Strategies on Offender-focused Investigations</p> <p>Justin Boardman</p> | | <p>How Would You Help? An OVC Conversation about Crime Victim Compensation</p> <p>Kristina Rose Will Bronson Kathrina Peterson</p> | <p>"Can't You Just Pray It Away?" The Intersectionality of Intimate Partner Violence & Spiritual Abuse</p> <p>Theresa Galen-Bruce</p> | | <p>Trauma-informed Legal Support for Survivors of Sex Trafficking</p> <p>★ +</p> <p>Patricia Hogue</p> | <p>The 4 Faces of Sexual Assault: Identifying Risk Factors in Sexual Assaults From the Title IX Perspective</p> <p>★ +</p> <p>Brikitta Hairston</p> | <p>SEARCH: The 4th Dimension of Crime: Technology Artifact Awareness</p> <p>🖥️</p> <p>John Trenary Christopher Dale</p> | <p>SEARCH: #howdoisearchthat: Leveraging Native Social Media Search Capabilities</p> <p>🖥️</p> <p>Lauren Wagner Eric Jollymore</p> | <p>HOTEL ROOM</p> <p>How to Work Aquatic Crimes Against Women Staged as Noncriminal Bathtub Deaths</p> <p>★ + 👤</p> <p>Andrea Zaferes Butch Hendrick</p> |
|---|--|--|---|--|--|---|---|--|---|

3:30-4:00pm

BREAK

4:00-5:30pm

| | | | | | | | | | |
|--|--|--|---|--|--|--|--|---|--|
| <p>"What's So Cool About It?" Pop Culture & its Impact on Crimes Against Women</p> <p>★ +</p> <p>Kathryn Marsh</p> | | <p>High Stakes, High Reward: Investing in a Domestic Violence High-Risk Team Model to Prevent Homicide</p> <p>Sarah Galgano Soleidi Alvarez Mercedes Santillanes Alicia Nuzzie</p> | <p>AirTag You're It: Combating Technology-based Stalking (SEARCH Lecture)</p> <p>John Trenary Lauren Wagner</p> | <p>ICCR Sexual Assault Roll Call Training Video Debut</p> <p>Lacy Hensley Demyia Pridden</p> | <p>Wayfinding in the Fight Against Trafficking: A Primer on How to Begin</p> <p>★ +</p> <p>Kirsta Melton</p> | <p>Dual Marginalization: The Unique Complexities of the LGBTQIA+ Community in Sex Trafficking</p> <p>★ +</p> <p>Rana Amini Jessica Brazeal</p> | | <p>SEARCH: Now What? Digesting Electronic Search Warrant Returns</p> <p>★ 🖥️</p> <p>Eric Jollymore Timothy Lott</p> | |
|--|--|--|---|--|--|--|--|---|--|

EVENING EVENTS

JOIN US FOR

HOWDY HOUR!

GRAND HALL | 5:30 - 7:30 PM

See pg. 5 for more information

TUESDAY MAY 21, 2024

6:00am-7:00am

TRAUMA-SENSITIVE YOGA | MYRA STRAND, STRAND² SQUARED SOLUTIONS - GRAND HALL

7:00am-8:00am

REGISTRATION & CONTINENTAL BREAKFAST (SEATING AVAILABLE IN GRAND HALL) - PRECONVENE AREA

LONE STAR A1 LONE STAR A2 LONE STAR A3/A4 LONE STAR B LONE STAR C1 LONE STAR C2 LONE STAR C3/C4 DALLAS A2/A3 DALLAS B

8:00am-9:30am

| | | | | | | | | |
|--|--|--|---|--|---|---|---|--|
| <p>Advocacy & Cultural Awareness for Latina Survivors</p> <p>Patricia Emmanuelli Paula Gomez Stordy</p> | <p>Firing Back: Discussing the Federal Law Enforcement's Role in Fighting DV & Firearm Violations</p> <p>Brian "Whitt" Garner Ashley Stephens</p> | <p>CASE STUDY: Second Chance at Justice: United States vs. U.S. Army Sergeant Timothy Hennis</p> <p>Robert Stelle</p> | <p>"Hurry, It's an Emergency!" Exploring EMS Responses to DV & Safety Implications on DV Calls</p> <p>Robert Frechette</p> | <p>The Investigative Mindset: What Law Enforcement Should Look for & Listen for at DV Crime Scenes</p> <p>Dave Thomas</p> | <p>A Number of Options! Fourteen Strategies for Promoting Abuser Engagement & Accountability</p> <p>David Adams (Emerge) Zachary Moser</p> | <p>CASE STUDY: Stalking Terror: A "Hollywood" DNA Analyst & Real-World Forensic Genetic Genealogy Intervention</p> <p>Steve Kramer Steve Busch</p> | <p>Choosing Life When Death Appears Like the Best Option: Navigating Victim Suicidal Ideations</p> <p>Mylira Green</p> | <p>Down to Brass Tacks: Enhancing Human-centric & Trauma-informed Investigations & Prosecutions</p> <p>Russell Strand</p> |
|--|--|--|---|--|---|---|---|--|

9:30am-10:00am

BREAK

10:00am-11:30am

| | | | | | | | | |
|--|--|---|---|---|--|--|--|--|
| <p>Within the Ranks: Implications of Officer-involved Domestic & Sexual Violence</p> <p>Mark Wynn</p> | <p>Credibility or Corroboration: The Role of Fear & Survival in Investigations and Prosecutions of Crimes Against Women</p> <p>Kelsey McKay</p> | <p>CASE STUDY: Connecting Missing Links: ViCAP as a Resource for Violent Crime Investigations</p> <p>Christine DePoyster Kathleen Welch-Teague</p> | <p>The Impactful Influence of Male Advocacy within Law Enforcement & Military Spaces</p> <p>Tony Porter Rickie Houston Major Kay</p> | <p>"What if?" Reframing the Story of Survivorship Across the Lifespan of a Native Woman</p> <p>Nicole Matthews Ingrid Anderson</p> | <p>Justice in Action: Post-Arrest Investigative Practices for Gender-based Violence</p> <p>John Guard</p> | <p>CASE STUDY: Shattered Summer: Unraveling a DV Fatality through Technology Evidence</p> <p>Eric Jollymore</p> | <p>The Military DV Advocacy Village: How Process & Resources Support Victims</p> <p>Lisa Eaffaldano Fe Villegas</p> | <p>"Am I Crazy?" The Ramifications of Gaslighting & its Impact on Survivors</p> <p>Whitney Ball</p> |
|--|--|---|---|---|--|--|--|--|

11:30am-12:00pm

BREAK

12:00pm-1:30pm

| | | | | | | | | |
|--|--|---|---|--|---|---|--|---|
| <p>Reimagining Coordinated Community Response: Centering Survivors & Culturally-specific Realities</p> <p>Amalfi Parker Elder</p> | <p>Coming Out about IPV in the LGBTQ+ Community</p> <p>Kendra Eggleston Jessica Sanchez</p> | <p>Office for Victims of Crime: Expanding Services for American Indian/Alaska Native Women</p> <p>LeBretia White</p> | <p>Healing Together: Strategies for Building Pet-inclusive Services for Survivors & their Pets</p> <p>Samantha Hinchey</p> | <p>Strengthening Community Trust: Storytelling and Language Access as a Pathway to Organizational Transformation</p> <p>Natasha Haunsperger Toc Suneoulay-Gillespie</p> | <p>From the Ground Up! Enhancing Community Engagement Related to Gender-based Violence</p> <p>Flor Louis</p> | <p>A Holistic Toolkit: Equipping Clinicians with Integrative Trauma Treatment Strategies</p> <p>Melissa Harrison</p> | <p>Keep Calm & Understand U.S. vs. Rahimi</p> <p>Jonathan Kurland</p> | <p>Why Culture Matters in Preventing Domestic Violence Homicide</p> <p>Michelle Toledo Caines Raysa Guerrero Sarah Henry</p> |
|--|--|---|---|--|---|---|--|---|

1:30-2:00pm

BREAK

2:00-3:30pm

| | | | | | | | | |
|--|--|---|---|--|--|--|--|---|
| <p>Addressing Intersections: Exploring Racialized Trauma & Violence Against Women</p> <p>Amber Foster</p> | <p>"If It Were Only That Simple:" Enhancing Advocacy for Domestic Violence Victims & Survivors</p> <p>Leslie Morgan Steiner</p> | <p>CASE STUDY: Malevolent Intentions: A Murder-for-Hire Case</p> <p>Marissa Hatchett Christopher Sawyer Cruz Hernandez</p> | <p>First Responding Officer: A Victim-Centered Patrol Response to Sexual Violence Cases</p> <p>Kenny Smith</p> | <p>Proceeding without Participation: Evidence-based Prosecution of DV Cases</p> <p>Rebecca Sinnott Bunn Erin McEnaney</p> | <p>... And Justice for All: Responding to Violence against Sexually Exploited Individuals</p> <p>Miiko Anderson Jane Anderson</p> | <p>Aiming for Safety: Trauma-Informed Harm Reduction, Risk Assessment, & Safety Planning</p> <p>Myra Strand</p> | <p>Building Relationships for a Healthier Future: Law Enforcement & Transgender Communities</p> <p>Denise Jones Michael Crumrine Michael Munson</p> | <p>Coercive Control 101: Using Research to Identify Predominate Aggressors in They Said/They Said Cases</p> <p>Patrick Brady</p> |
|--|--|---|---|--|--|--|--|---|

3:30-4:00pm

BREAK

4:00-5:30pm

| | | | | | | | | |
|--|---|--|---|--|---|--|--|--|
| <p>Emerging from the Silos: Successfully Serving Survivors of Abuse & Holding Offenders Accountable</p> <p>Robert Frechette</p> | <p>Knowing Where to Look: Immigration Relief for Undocumented Victims of Crime</p> <p>Rosie Martinez</p> | <p>Probation & Parole Strategies to Disarm DV Offenders</p> <p>Jennifer Waindle</p> | <p>Standing Up an Organization: Wide Coordinated Community Response Across the Department of Defense</p> <p>Kathleen Chiarantona Vince Heitman Fe Villegas</p> | <p>"Put Your Oxygen Mask On First:" Exploring PTSD & Suicide Amongst Telecommunicators & Responders</p> <p>Jason Long</p> | <p>Crime Scene Conversations: Putting Protocol into Practice</p> <p>Dan Rincon</p> | <p>Embracing Culture within a Community Response to Missing or Murdered Indigenous Women/People</p> <p>Brie Bennett Nathan Barton Valerie Bribescas</p> | <p>"Let's Correct Course": Examining DV Intervention Programs to Enhance Offender Accountability</p> <p>Brandy Dailey</p> | <p>Hey Siri, How Do You Increase Accountability & Safety in Stalking Cases?</p> <p>Jennifer Landhuis Denise Jones</p> |
|--|---|--|---|--|---|--|--|--|

EVENING EVENTS

LETTAC

MEET THE EXPERT OFFICE HOURS

Sign ups required - see the Conference App

6:00-7:00pm

TRAUMA-SENSITIVE YOGA

Myra Strand, Strand² Squared Solutions

6:00-7:00pm | GRAND HALL



★ MCLE ELIGIBLE
+ CNE ELIGIBLE

🔍 CASE STUDY
👤 INTERACTIVE

💻 COMPUTER LAB
🔄 REPEAT

*RESTRICTION - SEE MOBILE APP FOR MORE INFORMATION

SCHEDULE

DALLAS C DALLAS D1 DALLAS D2/D3 SAN ANTONIO HOUSTON A HOUSTON B HOUSTON C STATE ROOM 1 SAN ANTONIO B

8:00am-9:30am

| | | | | | | | |
|--|---|--|--|---|---|--|--|
| <p>Exposing the Abuser's Playbook: Advocacy Strategies for Victims with Disabilities</p> <p>★ +</p> <p>Scott Hampton</p> | <p>Identifying, Preserving, & Presenting Digital Evidence in Stalking Cases</p> <p>★</p> <p>Jennifer Landhuis Jane Anderson</p> | <p>Alcohol: A Sex Offender's Weapon & Shield</p> <p>★ +</p> <p>Julie Germann</p> | <p>Multi-jurisdictional Responses to Domestic Violence & Sexual Assault in Indian Country</p> <p>★ +</p> <p>Leslie Hagen</p> | <p>Strategies for Human Trafficking Investigations & Prosecutions</p> <p>★ +</p> <p>Joseph Scaramucci Rochelle Keyhan</p> | <p>SEARCH: Practical Tools for Data Insights & Analysis</p> <p>💻</p> <p>John Trenary Christopher Dale</p> | <p>SEARCH: Become a Google Jedi: Building a Better Boolean String</p> <p>💻</p> <p>Lauren Wagner Eric Jollymore</p> | <p>HOTEL POOL</p> <p>Aquatic Crimes Against Women Staged as Noncriminal Swimming Pool & Open Water Deaths</p> <p>★ + 🤝</p> <p>Andrea Zaferes Butch Hendrick</p> |
|--|---|--|--|---|---|--|--|

9:30am-10:00am

BREAK

10:00am-11:30am

| | | | | | | |
|---|---|---|--|--|---|--|
| <p>"Speaking Louder Won't Help:" Addressing Limited English Proficiency within GBV Investigations</p> <p>+</p> <p>Natasha Haunsperger</p> | <p>Walking Away with Insight into Financial Abuse & Economic Justice</p> <p>★</p> <p>Ruth Guerreiro</p> | <p>Collegiate Collaboration: Exploring Campus-informed Partnership Strategies</p> <p>+</p> <p>Jennifer Sterling James Randles</p> | <p>Writing It Right: Documenting Human Trafficking for Investigators to Strengthen Prosecutor Cases</p> <p>★</p> <p>Jane Anderson Miiko Anderson</p> | <p>Lonely at the "Top:" Dispelling "Bottom Girl" Myths & Enhancing Advocacy for Sex Trafficking Victims</p> <p>★ 🔄</p> <p>Shamere McKenzie</p> | <p>SEARCH: Capturing and Preserving Online Videos</p> <p>★ 💻</p> <p>Lauren Wagner John Trenary Christopher Dale</p> | |
|---|---|---|--|--|---|--|

11:30am-12:00pm

BREAK

12:00pm-1:30pm

| | | | | | | | |
|--|--|--|---|---|--|---|--|
| <p>Justice May Be Blind, but Not Deaf: Services & Resources for Deaf or Hard of Hearing Survivors</p> <p>★ +</p> <p>Wilma Dennis</p> | <p>In Her Shoes: Economic Justice</p> <p>★ 🤝</p> <p>Ruth Guerreiro Jordyn Lawson</p> | <p>The Secondhand Smoke of Working with Survivors: Addressing Vicarious Trauma</p> <p>★</p> <p>Chelsea Davis</p> | <p>Tapping into Alternatives: How to Leverage the National Ashanti Alert Network to Enhance Investigations</p> <p>★</p> <p>Michelle Nickens Henry Oleyniczak Carri Gordon</p> | <p>Introducing a National Protocol Guiding Intimate Partner Violence Medical Forensic Exams</p> <p>+</p> <p>Jen Markowitz</p> | <p>Jails & Justice: Exploring Sexual & Intimate Partner Violence & the Criminal Justice System</p> <p>★ +</p> <p>Sarah Glenn</p> | <p>Using Community Policing Approaches to Address Labor Trafficking</p> <p>★</p> <p>Nazmia Comrie Evelyn Chumbow Amanda Armetta</p> | <p>From Adulthood to Ageism & Everything in Between</p> <p>★</p> <p>Rachel Gibson Audace Garnett</p> |
|--|--|--|---|---|--|---|--|

1:30-2:00pm

BREAK

2:00-3:30pm

| | | | | | | | |
|--|--|--|--|---|---|--|---|
| <p>Understanding the Intersectionality of Missing, Murdered, & Indigenous Women & Girls & Human Trafficking</p> <p>★ +</p> <p>Lynnette Grey Bull</p> | <p>How to Effectively Communicate with Survivors & Increase Participation</p> <p>★ +</p> <p>Jordyn Lawson Ruth Guerreiro</p> | <p>Under Close Scrutiny: Examining Principles for Effective Intervention & Supervision of IPV Offenders</p> <p>★</p> <p>Carolina Frane Susan Boyle</p> | <p>One Size Doesn't Fit All: Working with African American Sex Trafficking Survivors</p> <p>★ +</p> <p>Hannah Counter Rana Amini</p> | <p>From Trauma to Empowerment: The Importance of Sexual Healing for Survivors</p> <p>+</p> <p>Laramie Gorbett Tiffany Lee</p> | <p>"I'm Just a Bill:" The Importance of Developing a Human Trafficking Policy Framework</p> <p>★ +</p> <p>Kirsta Melton</p> | <p>SEARCH: Shining Light on the Darknet: Darknet Awareness</p> <p>★ 💻</p> <p>Timothy Lott Eric Jollymore</p> | <p>SEARCH: Writing Legal Process for Digital Investigations</p> <p>💻</p> <p>John Trenary Christopher Dale Lauren Wagner</p> |
|--|--|--|--|---|---|--|---|

3:30-4:00pm

BREAK

4:00-5:30pm

| | | | | | | | |
|--|---|--|--|---|---|--|---|
| <p>Law Enforcement Supporting the LGBTQ+ Survivor in the Campus Setting</p> <p>+</p> <p>Valerie Garcia Sabrina Blevins</p> | <p>Beyond Fight, Flight, Freeze: The Neurobiology of Fawning & Appeasement</p> <p>+</p> <p>Ruby Jo Walker</p> | <p>Reward in Retrospection: Safety Planning for the Family Law Case</p> <p>★</p> <p>Sara Barnett</p> | <p>Hierarchy of Needs: Analyzing Culpability & Victimization within Prostitution Organizations</p> <p>★ +</p> <p>Brooke Grana-Robb</p> | <p>And in Your Town Today... An Undocumented Woman Was Trafficked (Again)</p> <p>★ +</p> <p>Hillary Walsh</p> | <p>Teaching to the "Tech:" Trafficking Operations to Identify Trafficking Victims & Offenders</p> <p>★</p> <p>Eric Jollymore John Trenary</p> | <p>SEARCH: Virtual Treasure Troves: User Account Downloads</p> <p>★</p> <p>Eric Jollymore John Trenary</p> | <p>SEARCH: Digital Detective: Unleashing the Power of OSINT</p> <p>★</p> <p>Lauren Wagner Christopher Dale Timothy Lott</p> |
|--|---|--|--|---|---|--|---|



"LOUD ENOUGH" FILM SCREENING
Justin Boardman, Julie Germann, Madison Smith, Engel Productions
6:00-8:00pm | LONE STAR A3/A4

WEDNESDAY MAY 22, 2024

7:00am-8:00am

REGISTRATION & CONTINENTAL BREAKFAST (SEATING AVAILABLE IN GRAND HALL) - PRECONVENE AREA

7:45am-9:30am

NEW FRIENDS NEW LIFE BREAKFAST & FACILITY TOUR | SEE BELOW FOR MORE DETAILS

| LONE STAR A1 | LONE STAR A2 | LONE STAR A3/A4 | LONE STAR B | LONE STAR C1 | LONE STAR C2 | LONE STAR C3/C4 | DALLAS A2/A3 | DALLAS B |
|--------------|--------------|-----------------|-------------|--------------|--------------|-----------------|--------------|----------|
|--------------|--------------|-----------------|-------------|--------------|--------------|-----------------|--------------|----------|

8:00am-9:30am

| | | | | | | | | |
|---|--|--|---|---|--|--|---|---|
| <p>Leadership in Law Enforcement As It Relates To Special Victim & Domestic Violence Units</p> <p>★</p> <p>Dan Rincon</p> | <p>"Order in the Court!" Examining Trauma in the Legal System</p> <p>★</p> <p>Amanda Elkanick-Oder Bronwyn Blake</p> | <p>CASE STUDY: Second Chance at Justice: United States vs. U.S. Army Sergeant Timothy Hennis</p> <p>★ 🔍 ↻</p> <p>Robert Stelle</p> | <p>Voices of Strength: Public Safety Telecommunicators in Responding to Crimes Against Women</p> <p>★</p> <p>Dominique Mathis</p> | <p>Behind the Black Robe: Equipping the Court in Gender-based Violence Cases</p> <p>★</p> <p>Kirsta Melton Tanner Neidhardt</p> | <p>Victim to Offender: The Unintended Consequence of the Criminal Justice Response to Domestic Violence</p> <p>★</p> <p>Jeanne Mullane</p> | <p>A Matrix of Madness: Examining the Minds & Motivations of Sexual Deviant Killers</p> <p>★ +</p> <p>Lawrence Simon</p> | <p>Collaborating for Justice for Older African Americans: Key Strategies for Equitable Partnerships</p> <p>★</p> <p>Victoria Ferguson-Young Kristin Burki</p> | <p>VPN Investigations (SEARCH Lecture)</p> <p>★</p> <p>Timothy Lott</p> |
|---|--|--|---|---|--|--|---|---|

9:30am-10:00am

////////////////////// BREAK ////////////////////////

10:00am-11:30am

| | | | | | | | | |
|---|--|---|--|---|---|--|---|---|
| <p>Communication is Key! Enhancing Safety Through Language Access in Domestic Violence Cases</p> <p>★</p> <p>Jose Juan Lara, Jr. Lumarie Orozco</p> | <p>IPV & Firearm Prohibitions: Strengthening Response Through Knowledge & Collaboration</p> <p>★</p> <p>Darren Mitchell John Guard</p> | <p>CASE STUDY: On a Massive Scale: Targeted Violence & Mass Attacks Against Women: A Comparative Case Analysis</p> <p>★ 🔍</p> <p>Allanah Hund Taylor Hartwell</p> | <p>Accident, Suicide, or Murder?: Exploring the Ways Intimate Partner Homicides Can be Staged</p> <p>★</p> <p>Nancy Tardibuono Andrea Zaferes Kenneth Rosgen</p> | <p>The C-Suite: Culture, Connection, & Collaboration for Culturally-specific Survivors</p> <p>★</p> <p>Gretta Gardner Karma Cottman</p> | <p>From Headlines to Parole Presentations: Survivors of IPV Caught in the Criminal Justice System</p> <p>★</p> <p>Margaret Bassett Jeana Lungwitz</p> | <p>"But Isn't He Still a Good Dad?" DV Offender Manipulation Tactics During Post-Separation</p> <p>★</p> <p>Ruth Guerreiro</p> | <p>Tactical Advocacy: 10 Key Practices for Police to Add to their Toolkit</p> <p>★</p> <p>Kristin Daley Kenny Smith</p> | <p>Too Scared to Speak: Prosecuting Non-Fatal Strangulation Cases without Victim Participation</p> <p>★ +</p> <p>Patrick Brady Kelsey McKay</p> |
|---|--|---|--|---|---|--|---|---|

11:30am-12:00pm

////////////////////// BREAK ////////////////////////

12:00pm-1:30pm

| | | | | | | | | |
|---|---|--|--|--|--|---|---|--|
| <p>"Count Us In!" Engaging Men Through an Intersectional Lens to Help End Violence Against Women</p> <p>★</p> <p>Lina Juarbe Botella Rickie Houston</p> | <p>Poly-Victimization: Connecting the Dots with Intimate Partner Violence</p> <p>★</p> <p>Kim Camacho</p> | <p>Abuse, Violence, & Bulimia: The Complicated Common Thread of Complex Trauma</p> <p>+</p> <p>Suzanne Kramer-Brenna</p> | <p>The Gendered Pathway: Criminal-legal System-impacted Women & Girls</p> <p>★</p> <p>Jaya Davis</p> | <p>The Link Between Family Violence & Animal Cruelty</p> <p>★</p> <p>Jessica Trevizo Kishwer Lakhani</p> | <p>OUCH! Trauma Mitigation through Policy, Procedure, & Practice</p> <p>+</p> <p>Jason Lundquist Autumn Vandegrift</p> | <p>Criminal or Noncriminal? Respiration & Asphyxiation Physiology Investigations</p> <p>★ +</p> <p>Andrea Zaferes</p> | <p>OVW Tribal Affairs: Addressing the Issues of Violence Against American Indian & Alaska Native Women</p> <p>★</p> <p>Tammy Ashley Jenny Mills</p> | <p>The Connection Between Language Access & Trauma-informed Crime Victims Advocacy</p> <p>★ +</p> <p>Jose Juan Lara, Jr.</p> |
|---|---|--|--|--|--|---|---|--|

1:30-2:00pm

////////////////////// BREAK ////////////////////////

2:00-3:30pm

| | | | | | | | | |
|---|---|--|--|---|--|---|--|--|
| <p>Finding & Helping the Hidden Victims: Responding to Children Exposed to Violence in the Home</p> <p>★</p> <p>Mark Wynn</p> | <p>"It Could Have Been Me:" A Survivor's Story of Stalking</p> <p>★</p> <p>Jennifer Landhuis Caitlin Mathis</p> | <p>Social Media, Surveillance, & Sexting: The Complex Realities of Teen Dating Violence</p> <p>★</p> <p>Audace Garnett</p> | <p>From Petition to Protection: Innovations & Approaches to Ensure Effective P.O. Processes</p> <p>★</p> <p>Darren Mitchell John Guard Lauren Dennis</p> | <p>CASE STUDY: Betrayed by the System: An Immigrant Mother's Journey to Protect Her Child</p> <p>★ 🔍</p> <p>Pathak "Pooja" Amber Theresa Neyland Amy Watson</p> | <p>Closing a Lethal Gap: Firearm Implications Related to the New Dating Violence Prohibitor</p> <p>★</p> <p>Monica Player Jennifer Becker Jennifer Waindle John Keough Eileen Husslebaugh Angela Vandergrift</p> | <p>Scrolling with Purpose: Mastering the Art of Social Media Searching</p> <p>★</p> <p>Lauren Wagner Timothy Lott</p> | <p>Suffer from BURNOUT, give'em the F.I.N.G.E.R.!</p> <p>★</p> <p>Mark Yarbrough</p> | <p>It's in the Details: Documenting the DV Investigation & Why What is Written Matters</p> <p>★</p> <p>Kimberly Orts</p> |
|---|---|--|--|---|--|---|--|--|

3:30-4:00pm

////////////////////// BREAK ////////////////////////

4:00-5:30pm

| | | | | | | | | |
|--|--|--|--|---|---|---|--|---|
| <p>Deep Reflection: Analyzing Narcissism & its Role in Gender-based & Domestic Violence Relationships</p> <p>★</p> <p>Ramani Durvasula</p> | <p>Complex Lives, Complex Strategies: Child-Related Relief in Protection Order Proceedings</p> <p>★</p> <p>Monica Player</p> | <p>CASE STUDY: Strangulation & Stroke at 23: Medical Attention within Tribal Cases</p> <p>★ + 🔍</p> <p>David Adams (Parnall)</p> | <p>No Longer Just a Piece of Paper: DV Offender Monitoring with Victim Notification</p> <p>★</p> <p>Tanya Wallstein Bryan Farrell Fidelis Leasiolagi</p> | <p>How To Effectively Utilize Shelter Services for Victims of Gender-based Violence... Or Should You?</p> <p>★</p> <p>Jordyn Lawson</p> | <p>Upping the Ante: Strategies on How to Enhance On-Scene & Follow-Up DV Investigations</p> <p>★</p> <p>Kimberly Orts</p> | <p>The Reasonable Belief of Danger: Identifying Self-Defense & Mutual Combat Cases</p> <p>★</p> <p>Kelsey McKay Scott Hampton</p> | <p>Answering the Call: Strategies to Overcome DV & Telecommunications Challenges</p> <p>★</p> <p>Jennet Sullivan</p> | <p>Building Trust with Victims & their Rights</p> <p>★</p> <p>Jessica Trevizo Shanika Davis</p> |
|--|--|--|--|---|---|---|--|---|



NEW FRIENDS NEW LIFE BREAKFAST & FACILITY TOUR

7:45-9:30am | Buses load at 7:15am at valet pick-up in front of the Sheraton. Pre-registration & \$20 fee is required.

EVENING EVENTS



MEET THE EXPERT OFFICE HOURS

Sign ups required - see the Conference App

6:00-7:00pm

★ MCLE ELIGIBLE

+ CNE ELIGIBLE



CASE STUDY

INTERACTIVE



COMPUTER LAB



REPEAT

*RESTRICTION - SEE MOBILE APP FOR MORE INFORMATION

SCHEDULE

DALLAS C DALLAS D1 DALLAS D2/D3 SAN ANTONIO HOUSTON A HOUSTON B HOUSTON C STATE ROOM 1 SAN ANTONIO B

8:00am-9:30am

| | | | | | | | | |
|---|--|--|---|--|---|--|--|--|
| <p>Hand in Hand: A Multidisciplinary Co-Response Approach to Addressing Gender-Based Violence</p> <p>★</p> <p>Denise Jones Lauren Dennis Rebecca Sinnott Bunn</p> | | <p>Evolve to Solve: Analyzing Lessons Learned in Implementing Law Enforcement-based Victim Services</p> <p>Paige Presler-Jur Shelby Hopson Melissa Padilla</p> | <p>Thinking Outside of the (Witness) Box: Exploring Crawford & Forfeiture by Wrongdoing Prosecutions</p> <p>★</p> <p>Gerald Fineman</p> | <p>When IPV & Strangulation Impact Those We Least Expect: Forensic Nursing & Prosecutorial Perspectives</p> <p>+</p> <p>Khara Breedon Kimberly Smith Jaime Wallace</p> | <p>"Wait, I've Changed My Mind!" Recantation vs. False Reporting in Sexual Violence Cases</p> <p>★ +</p> <p>Kenny Smith</p> | <p>It's Not One Dimensional: Advocacy for Indigenous Victims of Trafficking in North America</p> <p>★ +</p> <p>Rochelle Keyhan Lynnette Greybuhl</p> | <p>SEARCH: Making Sense of Mobile Forensics (Pt. 1)</p> <p>★</p> <p>Christopher Dale</p> | |
|---|--|--|---|--|---|--|--|--|

9:30am-10:00am

BREAK

10:00am-11:30am

| | | | | | | | | |
|---|--|--|--|---|--|--|--|--|
| <p>Improving Resources to Address Missing & Murdered Indigenous Persons & Other Tribal Needs</p> <p>Nazmia Comrie</p> | | <p>Beyond the Predominant Aggressor: Tackling "Upside-Down" Domestic Violence Cases</p> <p>★</p> <p>Kimberly Orts Laura Gorman</p> | <p>911 is NOT a Joke! How Dispatchers Contribute as DV First Responders</p> <p>+</p> <p>Jason Long</p> | <p>Addressing VAWA Crimes in Higher Education through Whole-Campus Approaches</p> <p>★ +</p> <p>Elise Lopez</p> | <p>Forensics at its Finest: Examining the SANE Approach for Effective Prosecution of Sexual Assault</p> <p>+</p> <p>Patti Powers Julie Valentine</p> | <p>A Strategy for Success: Bringing Traffickers to Trial</p> <p>★ +</p> <p>Kirsta Melton</p> | <p>SEARCH: Making Sense of Mobile Forensics (Pt. 2)</p> <p>★</p> <p>Christopher Dale</p> | |
|---|--|--|--|---|--|--|--|--|

11:30am-12:00pm

BREAK

12:00pm-1:30pm

| | | | | | | | | |
|--|--|--|---|--|---|--|--|--|
| <p>The Coast is Not Always Clear: Post-Conviction Services for Victims & Survivors</p> <p>Libby Hamilton Mark Odum</p> | | <p>Dying a Slow Death: The Negative Effects of Stalking</p> <p>Anna Nasset</p> | <p>Deserve to be Heard: Considerations for Communicating with Individuals Who Do Not Speak</p> <p>★ +</p> <p>Kate Homan</p> | <p>Sea Legs for Survivors: Enriching Victim Interviews through a Military Justice Team Approach</p> <p>★</p> <p>Jennifer White Erin Callahan</p> | <p>When Your Race Speaks Before You Can: Cultural Considerations in Sexual Assault Investigations</p> <p>★ +</p> <p>Brikiita Hairston</p> | <p>Not a Happy Ending: The Backdrop of Atlanta and What Really Happens in Illicit Massage Businesses</p> <p>★ +</p> <p>Chris Muller-Tabanera YungXi Wang Jenny Yip</p> | <p>"Ain't I a Woman?" Misogynoir, Technology-Facilitated Crimes and the Intersection with IPV</p> <p>★</p> <p>Rachel Gibson Audace Garnett</p> | |
|--|--|--|---|--|---|--|--|--|

1:30-2:00pm

BREAK

2:00-3:30pm

| | | | | | | | | |
|--|---|---|---|--|--|---|---|--|
| | <p>In Her Shoes: Domestic Violence</p> <p>★</p> <p>Ruth Guerreiro Jordyn Lawson</p> | <p>Paraphilic Sexual Gratification Motivations: Recognition, Investigation, & Prosecution</p> <p>+</p> <p>Andrea Zaferes Lawrence Simon</p> | <p>The New Era of Military Justice & Civilian Prosecution</p> <p>★</p> <p>Scott Goble</p> | <p>A View From the Inside: Utilizing an Adult Forensic Interview Program</p> <p>★ +</p> <p>Khara Breedon Daniela Hernandez Tiffany Larsen Michelle Sacks</p> | <p>Recognizing the Intersectionality of Individuals with Disabilities & Human Trafficking Victimization</p> <p>★ +</p> <p>Haley Patterson Heather Moga</p> | <p>Hidden in Plain Sight: Victims & Perpetrators of Labor Trafficking</p> <p>★</p> <p>Kirsta Melton</p> | <p>Using Google Earth to Plot Geolocation Points, Create Maps, and Visuals (Pt. 1)</p> <p>John Trenary Timothy Lott</p> | |
|--|---|---|---|--|--|---|---|--|

3:30-4:00pm

BREAK

4:00-5:30pm

| | | | | | | | | | |
|--|--|---|--|---|--|--|--|---|--|
| | | <p>Blue Silence: Addressing Gender-based Violence in the Law Enforcement Family</p> <p>★</p> <p>Denise Jones John Guard</p> | <p>Averting Landmines: Trauma-informed Approaches to Preparing Clients for Civil Litigation</p> <p>★</p> <p>Heather Crawford</p> | <p>Standing Up to Scrutiny: Cross-examination Strategies for Prosecutors</p> <p>★</p> <p>Rebecca Sinnott Bunn</p> | <p>The Difference Between Justice & Injustice: Writing Accurate Sexual Violence Police Reports</p> <p>★</p> <p>Kenny Smith</p> | <p>Identity Theft: The Tactics of Emotional Abuse & Isolation</p> <p>Jessica Brazeal</p> | <p>You Down With OPP (Other People's Python)?</p> <p>Lauren Wagner Eric Jollymore Christopher Dale</p> | <p>Using Google Earth to Plot Geolocation Points, Create Maps, and Visuals (Pt. 1)</p> <p>John Trenary Timothy Lott</p> | |
|--|--|---|--|---|--|--|--|---|--|

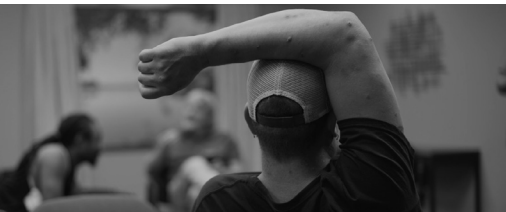

"BEHIND THE RAGE" FILM SCREENING

Leslie Morgan Steiner, David Adams, Dorthy Stucky Halley, Steve Halley 6:00-8:00pm | LONE STAR A3/A4

TRAUMA-SENSITIVE YOGA

Myra Strand, Strand² Squared Solutions 6:00-7:00pm | GRAND HALL

THURSDAY MAY 23, 2024

7:00am-8:00am REGISTRATION & CONTINENTAL BREAKFAST (SEATING AVAILABLE IN GRAND HALL) - PRECONVENE AREA

| | | | | | | | | |
|--------------|--------------|-----------------|-------------|--------------|--------------|-----------------|--------------|----------|
| LONE STAR A1 | LONE STAR A2 | LONE STAR A3/A4 | LONE STAR B | LONE STAR C1 | LONE STAR C2 | LONE STAR C3/C4 | DALLAS A2/A3 | DALLAS B |
|--------------|--------------|-----------------|-------------|--------------|--------------|-----------------|--------------|----------|

8:00am-9:30am

| | | | | | | | | |
|---|---|---|---|---|--|--|---|---|
| <p>Debunking the Myths Surrounding PTSD as a Defense to Special Victim Crimes</p> <p>★</p> <p>Bridget Ryan</p> | <p>Collaborative Approach to Evidence-based Prosecution of DV Cases at the Granular Level</p> <p>★</p> <p>Kimberly Orts Laura Gorman</p> | <p>A Matrix of Madness: Examining the Minds & Motivations of Sexual Deviant Killers</p> <p>★ + ↻</p> <p>Lawrence Simon</p> | <p>Averting Landmines: Trauma-informed Approaches to Preparing Clients for Civil Litigation</p> <p>★ ↻</p> <p>Heather Crawford</p> | <p>Suffer from BURNOUT, give'em the F.I.N.G.E.R.!</p> <p>★ ↻</p> <p>Mark Yarbrough</p> | <p>Authentic Advocacy & Lessons Learned: Addressing a Macro Problem on a Micro Level</p> <p>Karen DiBella</p> | <p>CASE STUDY: Connecting Missing Links: ViCAP as a Resource for Violent Crime Investigations</p> <p>★ 🔍 ↻</p> <p>Christine DePoyster Kathleen Welch-Teague</p> | <p>"Am I Crazy?" The Ramifications of Gaslighting & its Impact on Survivors</p> <p>★ ↻</p> <p>Whitney Ball</p> | <p>Balancing the Scales: Strategies on Offender-focused Investigations</p> <p>↻</p> <p>Justin Boardman</p> |
|---|---|---|---|---|--|--|---|---|

9:30am-10:00am

////////////////////// **BREAK** ////////////////////////

10:00am-11:30am

| | | | | | | | | |
|---|--|--|--|--|--|---|---|---|
| <p>Communicating with Victims & Witnesses with Disabilities</p> <p>★ +</p> <p>Kate Homan</p> | <p>Creating Connection: Centering Trauma-informed Supervision</p> <p>Molly Voyles Jen Mudge</p> | <p>CASE STUDY: Broken Bodies: Broken Lives: The Movements of a Murderer</p> <p>★ 🔍</p> <p>Jessica Trevizo</p> | <p>What Color is Your Rainbow? Law Enforcement Best Practices for Supporting LGBTQ+ Communities</p> <p>★</p> <p>Lauren Dennis Michael Crumrine Denise Jones</p> | <p>CASE STUDY: No Diamond in the Rough: The Capture & Conviction of Billy Chemirmir</p> <p>🔍 ↻</p> <p>Glen Fitzmartin</p> | <p>CASE STUDY: Malevolent Intentions: A Murder-for-Hire Case</p> <p>★ 🔍 ↻</p> <p>Marissa Hatchett Christopher Sawyer Cruz Hernandez</p> | <p>"But Isn't He Still a Good Dad?" DV Offender Manipulation Tactics During Post-Separation</p> <p>★ ↻</p> <p>Ruth Guerreiro</p> | <p>It Takes a Community: Building Partnerships Between Tribal Advocate Programs and Tribal Colleges and Universities</p> <p>Raquel DeHerrera</p> | <p>Law Enforcement & Multi-Disciplinary Team Approaches</p> <p>↻</p> <p>Dan Rincon</p> |
|---|--|--|--|--|--|---|---|---|

////////////////////// **CONFERENCE ADJOURNS** ////////////////////////



DOWNLOAD THE APP!

HOW TO GET THE APP:

- Search Apple Store or Google Play for "CCAW" and download
- Once in the app, click the download button and then press the arrow to enter into the event
- Log in with your credentials and enter the verification code sent to your email address and/or phone number

Visit the Help Desk with any questions. We are happy to help!

Represent this year's 19th Annual CCAW or show your passion for ending violence against women with conference merch.

VISIT THE CCAW BOOTH TO GRAB YOURS TODAY!



Fleece \$40



Polo \$30



T-Shirt \$20



Blanket \$15



Mug \$10

★ MCLE ELIGIBLE

+ CNE ELIGIBLE

🔍 CASE STUDY

👉 INTERACTIVE

💻 COMPUTER LAB

🔄 REPEAT

*RESTRICTION - SEE MOBILE APP FOR MORE INFORMATION

DALLAS C DALLAS D1 DALLAS D2/D3 SAN ANTONIO HOUSTON A HOUSTON B HOUSTON C STATE ROOM 1 SAN ANTONIO B

8:00am-9:30am

| | | | | | | |
|---|--|---|--|---|---|--|
| <p>One Person Can Make a Difference: The Creation of a Firearms Surrender Unit</p> <p>★ +</p> <p>Jordan Ferguson</p> | <p>The Coast is Not Always Clear: Post-Conviction Services for Victims & Survivors</p> <p>★ +</p> <p>Libby Hamilton Mark Odom</p> | <p>It Ain't Easy Being Green: Addressing the Challenges of Adolescent Sexual Assault Victims & Suspects</p> <p>+</p> <p>Michael Crumrine Rachael Frost</p> | <p>Sticks & Stones: The Language Used to Talk About Sexual Violence Matters</p> <p>★ +</p> <p>Kristin Daley Kenny Smith</p> | <p>A View From the Inside: Utilizing an Adult Forensic Interview Program</p> <p>★ + 🔄</p> <p>Khara Breedon Daniela Hernandez Tiffany Larsen Michelle Sacks</p> | <p>One Size Doesn't Fit All: Working with African American Sex Trafficking Survivors</p> <p>★ + 🔄</p> <p>Hannah Counter Rana Amini</p> | <p>Decoding the Offender's Plan: Achieving Justice for Victims of Rape & IPH Cases</p> <p>★ +</p> <p>Patti Powers</p> |
|---|--|---|--|---|---|--|

9:30am-10:00am

////////////////////// BREAK //////////////////////////////////////

10:00am-11:30am

| | | | |
|---|--|---|--|
| <p>Deep Reflection: Analyzing Narcissism & its Role in Gender-based & Domestic Violence Relationships</p> <p>★ +</p> <p>Ramani Durvasula</p> | <p>The VINELink.com Experience: Delivering Resources to All Victims</p> <p>★ +</p> <p>Karen Adams Cassie Drochelman</p> | <p>Multi-jurisdictional Responses to Domestic Violence & Sexual Assault in Indian Country</p> <p>★ + 🔄</p> <p>Leslie Hagen</p> | <p>Not a Happy Ending: The Backdrop of Atlanta and What Really Happens in Illicit Massage Businesses</p> <p>★ + 🔄</p> <p>Chris Muller-Tabanera YunXi Wang Jenny Yip</p> |
|---|--|---|--|

////////////////////// CONFERENCE ADJOURNS //////////////////////////////////////



MMIW TEXAS REMATRIATE RED DRESS PROCESSIONAL

MMIW Texas Rematriate is a grassroots organization that educates and advocates for the MMIW/P crisis, not only in Indian Country, but in urban areas such as Dallas-Fort Worth (DFW). They support families in finding their missing/murdered Indigenous relatives and bringing them home in spirit or in flesh.

The RED DRESS Processional honors the women who have been lost due to violence. The dress MMIW Texas Rematriate leads showcases the color red, a color known to be sacred in many tribes. It is believed to transcend the physical world and call to those in the spirit world. During the processional, it is calling attention to those who have been missing or murdered.

SESSION HANDOUTS



Handouts are available on our Conference App and Attendee Hub at <https://event.me/EMg3M8>

HOW TO ACCESS HANDOUTS:

1. Navigate to either the Conference App or Attendee Hub online
** Make sure you are logged in **
2. Tap or click on the session you wish to access handouts from
3. Tap or click 'Add session' and refresh your page
4. On the app, scroll down until you see 'Attachments'
On Attendee Hub, look for 'Resources' on the right of your screen

If the session provides handouts, they will be available in those locations

NOTE: Not all sessions have handouts. No hard copies will be provided.

EXHIBITORS

A CALL TO MEN

The Next Generation of Manhood

A Call to Men works to promote healthy and respectful manhood and shift attitudes and behaviors that devalue women, girls, and those at the margins of the margins.



Amped Software USA, INC sets the standard for image and video forensics. The software solutions are used by the top law enforcement, military, and government agencies worldwide. The company focuses on developing global leading solutions for all image and video processing needs relating to forensics, investigations, public safety, and intelligence.

BIS Digital Inc. integrates AV technology and digital recording solutions. Customized, integrated AV solutions along with exceptional customer service and technical support are delivered.

Center for Violence Prevention Research conducts rigorous research that identifies what works to prevent violence against women and children. They increase the impact of their work by bridging the gap between community stakeholders and scientists.

CLEAT provides legal representation, lobbying, and legislative representation, local political action, collective bargaining and negotiations support, and a range of field-related services.

Crime Victims' Institute (CVI) is dedicated to conducting research and providing training on victimization-related issues. The mission of the CVI is to conduct research that examines the impact of crime on victims of all ages to promote a better understanding of victimization, improve services to victims, assist victims of crime by giving them a voice, and inform victim-related policy making at the state and local levels.

Dallas Children's Advocacy Center (DCAC) is in Dallas County, working in agreement with public and private agencies to investigate, prosecute, and provide healing services for child abuse cases in Dallas County. DCAC reduces the re-victimization of the child, removes barriers to investigation and treatment, and enhances criminal prosecution with a

distinctive multidisciplinary and united approach.

Dallas Police Department Explorers is for youth ages 14 to 21 who wish to consider law enforcement as a future career. The Department also has a Junior Explorer program for youth ages 9 to 14 years wherein they can advance to becoming an Explorer.

Damsel In Defense sells personal protection products that equip women to protect themselves. They also provide coaching on proper use of their tools and educate on strategies to enhance situational awareness.

Domestic Violence Resource Center for Increasing Safety and Connection is a national resource center led by the Center for Justice Innovation, Esperanza United, and Ujima Inc., that provides training and technical assistance on intimate partner violence (IPV) risk and lethality assessments.

End Violence Against Women International confronts interpersonal violence against adults and adolescents of all genders. They specialize in trauma-informed law enforcement responses—from the first interaction with a victim through the investigation and potential prosecution.

EZ Pain Relief offers medical-grade EMS/TENS therapy devices and percussion massage guns.

Foster & Freeman USA is an innovative company that focuses on forensic technology; pioneering the use of high-powered LEDs in forensic light sources with the original Crime-lite. Using their intelligent interface, Crime-lites are widely used to quickly and safely search for and detect trace evidence on victims such as bodily fluids and bruising.

Hair Districts for Women sells high quality hair tools and high quality hair products. They show women how to style hair with minimum effort and save time so they can always look & feel their best self.



Helpline Software allows you to reduce hotline burnout and predict it before it happens. They help to manage repeat/chronic callers, ensure reliability of the hotline, simplify making the shift schedules, automatically roll over calls according to the shift schedules, enable texting

for their landline numbers, and gives your advocates more time to answer.

It's A Hoot! is a woman-owned company specializing in fair trade and upcycled products. Focusing on advancement of women through teaching a trade.

Justice 3D is dedicated to providing advanced-level training and consulting for allied professionals who investigate and respond to violent crimes. Experience matters. Justice 3D stands for the importance of integrating the three dimensions of investigation, prosecution, and advocacy.

Lady of Elegance Boutique, LLC sells ladies jewelry and apparel.

Law Enforcement Training and Technical Assistance Consortium (LETTAC) prioritizes inclusivity including support for traditionally underserved jurisdictions such as rural and Tribal communities in assisting all law enforcement in strengthening the response to investigation and prosecution of intimate partner violence and Violence Against Women Act (VAWA) crimes in a trauma-informed manner, supporting victim healing, safety, and justice.

Legal Aid of NorthWest Texas is a 501(c)(3) that provides free civil legal services to the low-income population in North and West Texas. Attorneys provide legal services to survivors of domestic violence and human trafficking such as protective orders, divorce and custody, expunctions, driver's license restoration, housing, consumer, probate, bankruptcy, benefits, and other civil legal services.



Made for Freedom is working to fight human trafficking with style. Partnering with survivors of exploitation and those coming out of marginalized situations, they are able to create finely crafted goods and ethical fashion. Each piece is the result of dignified employment for those who desperately need it.

National Center for Victims of Crime (NCVC) forges a national commitment to help victims of crime rebuild their lives. NCVC is dedicated to serving individuals, families, and communities harmed by crime.



Navajo Jewelry and Crafts specializes in handcrafted Southwest Native American sterling silver jewelry made by family and extended family from the Navajo, Zuni, and Santo Domingo Tribe/Pueblos of New Mexico and Arizona. Handcrafted in sterling silver with natural stones and shells.



Naval Criminal Investigative Service (NCIS) defeats threats to the DON warfighter from across the foreign intelligence, terrorist, and criminal spectrum by conducting operations and investigations ashore, afloat, and in cyberspace. NCIS relies on a highly skilled, diverse, and agile professional workforce to navigate a rapidly evolving threat landscape.



Nightcap offers drink-spiking prevention products.

NW3C has developed and delivered economic crime investigation, high-tech crime investigation, digital forensics, criminal intelligence, and other criminal justice training and technical assistance. Federal funding allows NW3C to provide training and other services at no cost to state, local, tribal, and territorial criminal justice practitioners throughout the United States.

PSA Worldwide educates and spreads awareness on important topics such as the prevention of sexual assault, suicide, domestic violence, child abuse, harassment, substance misuse, discrimination, and more.

Red Wind Consulting, Inc. offers support to tribal and native-specific organizations addressing sexual assault, domestic and dating violence, stalking, and sex trafficking among tribal women.

ReloShare utilizes its instant-booking technology to power custom technology solutions for social service agencies, including Safe Stays - the first ever alias hotel booking service in the country - ensuring access to safe and reliable accommodations for clients and

sectors that have long been overlooked.



SafeGunLock is a new firearm locking device that is secure, portable, and quick to release in an emergency. SafeGunLock has many uses, including protecting kids in the home and eliminating access to firearms in situations that can reduce violence, gun theft, and suicide.

Self Esteem Shop is an independent, woman-owned bookstore that sells books, games, sensory items, and other developmental toys and tools. Self Esteem Shop sources all of the best resources and gets them all in one spot from basic development and socioemotional learning to specializing in "the tough stuff" including trauma, grief and loss, abuse, learning disabilities, Autism, and any other change or challenge.



Stronger Women is a non-profit providing transformative education to heal survivors of domestic abuse and violence. Since 2013, graduates have healed, drawn closer to God, and redefined their lives.

StrongHearts Native Helpline, Inc is a national, anonymous, and confidential helpline for AI/AN relatives experiencing or impacted by domestic or sexual violence.



Texas Advocacy Project has a mission to end dating and domestic violence, sexual assault, and stalking in Texas. Texas Advocacy Project empowers survivors through free legal services and access to the justice system, and advances prevention through public outreach and education.



Texas Native Health was created to fulfill the immediate needs of those living in the DFW Metroplex as a result of Public Law 959. Services include but are not limited

to: primary care, diabetes management, dental care, behavioral health counseling, pharmacy, tuition assistance, career training, human trafficking survivor counseling, cultural community, and education activities.

The Butterfly Effect: A Prekindergarten Prevention Curriculum is a pre-kindergarten, social-emotional learning curriculum that encourages protective factors and reduces risk factors for sexual violence. The Butterfly Effect is an eight-lesson curriculum based on CDC recommendations for preventing sexually violent crimes.



TXFNE: Forensic Center of Excellence empowers victims, promotes healing, and creates innovative and comprehensive solutions to fill gaps in victim services. A team of nurses and advocates provide medical forensic exams, adult forensic interviews, advocacy, and counseling support for survivors of sexual assault, intimate partner violence, human trafficking, child abuse, and elder maltreatment.

Ujima, The National Center on Violence Against Women in the Black Community is a national culturally specific organization, founded in 2015, that provides support to and is a voice for the Black community in response to domestic, sexual, and community violence. Through our education and outreach; training and technical assistance; resource development; research; and public policy, Ujima aims to mobilize the Black community and allies to strengthen families.



Vela is a secure data collection and reporting software for domestic and sexual violence programs. With more accurate data reporting, your organization can secure more funding, grow your capacity, and ultimately help more survivors.



VINE is the nation's leading victim notification network. It allows survivors, victims of crime, and other concerned citizens to access timely and reliable information about offenders or criminal cases in U.S. jails and prisons, where available.

SPONSORS

PLATINUM SPONSORS



GOLD SPONSORS



SILVER SPONSORS



COPPER SPONSORS



MEDIA SPONSORS



COMMUNITY SPONSORS

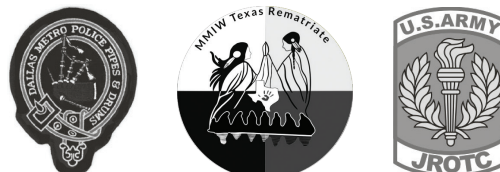



Guided by Mary Kay Ash's dream to enrich the lives of women everywhere, the **Mary Kay Ash Foundation** raises and distributes funds to invest in breakthrough cancer research to **find cures for cancers affecting women** and **ending domestic violence against women.**





The **Mary Kay Ash Foundation** has awarded more than **\$57 million** to **support domestic violence shelters, programs and services.**



Since 2000, **more than 2,800 organizations** advocating to **eradicate domestic violence** have received grants from the **Mary Kay Ash Foundation.**

marykayashfoundation.org

 [@marykayashfoundation](https://www.facebook.com/marykayashfoundation)

 [@marykaycares](https://www.instagram.com/marykaycares)



NEW FRIENDS *New Life* IS PROUD TO BE
A PARTNER FOR THE 19TH ANNUAL
CONFERENCE ON CRIMES AGAINST WOMEN.

New Friends New Life restores and empowers trafficked and sexually exploited teen girls, women, and their children, and drives awareness of the issue and its prevalence.

By providing assistance with immediate basic needs, trauma-informed counseling, legal advocacy, economic empowerment and educational support, NFNL is creating a community where women and girls can soar above the limits of their past to achieve their dreams.

 @newfriendsnewlife

 @newfriendsnewlife

 New Friends New Life

 @nfnlnews

FILM SCREENINGS

TUESDAY, MAY 21



LOUD ENOUGH

Justin Boardman, Julie Germann,
Madison Smith, Engel Entertainment

6:00-8:00pm | LONE STAR A3/A4

After surviving a life-threatening sexual assault in her hometown of Lindsborg, Kansas, college freshman Madison Smith and her parents were stunned when the local county prosecutor declined to file charges against the rapist, despite a strong case and compelling physical evidence. Traumatized by both the assault itself and her treatment by the police and prosecutor, Madison never wavered from the conviction that her attacker must be held accountable. She and her family refused to let the criminal justice system deny the facts and ignore her case, or to give up their quest for legal consequences.

WEDNESDAY, MAY 22

In America, most female homicide victims are killed by their current or former partner and one in four women experience domestic violence or abuse. In this documentary Peabody and Emmy-winning filmmaker Deeyah Khan ask a simple question: is it possible to reduce these endemic levels of male violence? In search of an answer, she hears heartfelt testimonies from survivors and victims' families, and gets vital insights from social workers and psychologists who work with violent men. And she speaks to those whose voices are rarely heard in conversations about domestic violence yet hold the key to stopping it: the perpetrators themselves.

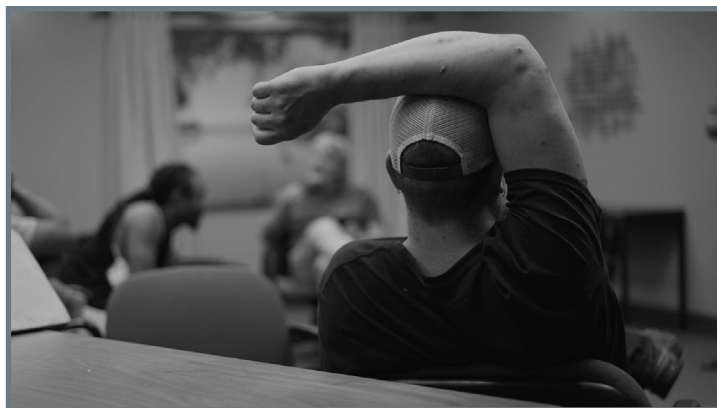

BEHIND THE RAGE

Leslie Morgan Steiner, David Adams,
Dorothy Stucky Halley, Steve Halley

6:00-8:00pm | LONE STAR A3/A4



CONFERENCE ON CRIMES AGAINST WOMEN

The National Conference on Crimes Against Women (CCAW) Advisory Council supports the mission of the conference while working with the CCAW team to help expand the reach of the conference and ensure timely and relevant training opportunities for law enforcement, prosecutors, advocates, nurses, campus personnel, and other first responders to the full spectrum of crimes against women.

Pete Angell

Special Agent, FBI, Palm Beach County RA

Justin Boardman

Retired Detective, Boardman Training & Consulting

Jessica Brazeal

Clinical Therapist, The Haven Wellness Center

Kenda Culpepper

DA, Rockwall County District Attorney's Office

Kaiti Dinges Blackburn

Executive Director, Jana's Campaign

Andrew Fifield

Detective, Dallas DPD-DV Unit

Gretta Gardner

Attorney, Ujima, Inc.

Julie Germann

Consultant, Finding the Right Inc.

Ruth Guerreiro

Clinical Therapist, Genesis Women's Shelter & Support

James Songer

Lt., Dallas Police Department - DV Unit

Anne Jackson

Attorney, McLennan County District Attorney's Office

Amy Jones

CEO, Dallas Area Rape Crisis Center

Rebekah Jones

Grants Program Specialist, OWW Tribal Affairs Division

Jan Langbein

CEO, Genesis Women's Shelter & Support

Nicole Matthews

Executive Director, Minnesota Indian Women's Sexual Assault Center

Kelsey McKay

Retired Prosecutor, RESPOND Against Violence

Cassandra Munoz

Probation Officer Supervisor, Franklin County Municipal Court

Kim Nash

Forensic Nursing Specialist, University of Colorado Health-Memorial Health System

Julie Owens

DV Consultant, Julie Owens Consulting

Michael Rizzo

Consultant, Institute for Intergovernmental Research

Elaina Roberts

Technology Safety Legal Manager, U.S. Dept of Justice, OWW

Jennifer Long

Senior Associate Attorney Advisor, AEquitas

Leslie Morgan Steiner

Consultant, Leslie Morgan Steiner Consulting

David Thomas

Consultant, Thomas Consulting & Training

Jerry Varney

Administrative Chief, Dallas County District Attorney's Office

Jennifer Waindle

Project Director, Battered Women's Justice Project

Mark Wynn

Retired Detective, Wynn Consulting

INTERESTED IN PRESENTING AT CCAW 2025?

The Request for Proposals for the 20th annual Conference on Crime Against Women will open in early June 2024 and will be posted online.

For additional questions, please contact Shawn Guy at sguy@conferencecaw.org.

CONFERENCE MAPS

PARKING IN DALLAS

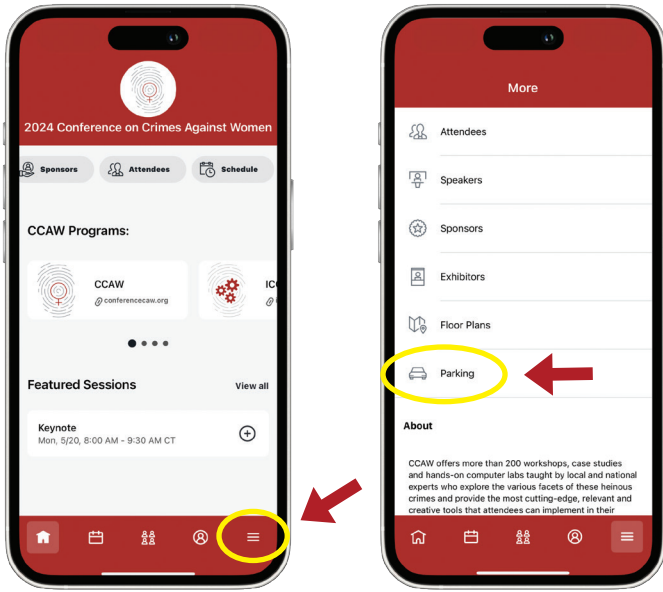

Navigate to the Conference App to access a list of parking lots nearby.

Follow the steps below:

1. On the Conference App homepage, click the menu button as shown above.
2. Choose 'Parking' to see a list of the parking lots near the Sheraton hotel.

You can access an interactive map to find directions and pricing for each lot.

1st FLOOR

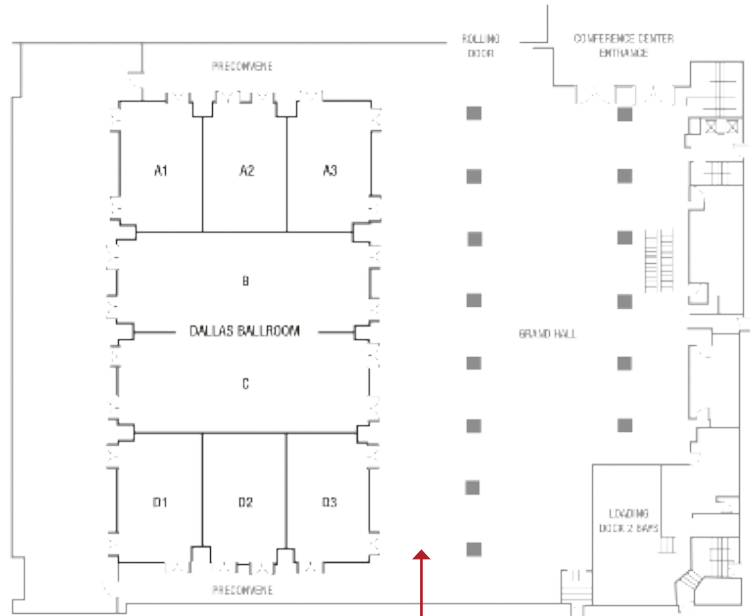

LUNCH KIOSKS

2nd FLOOR

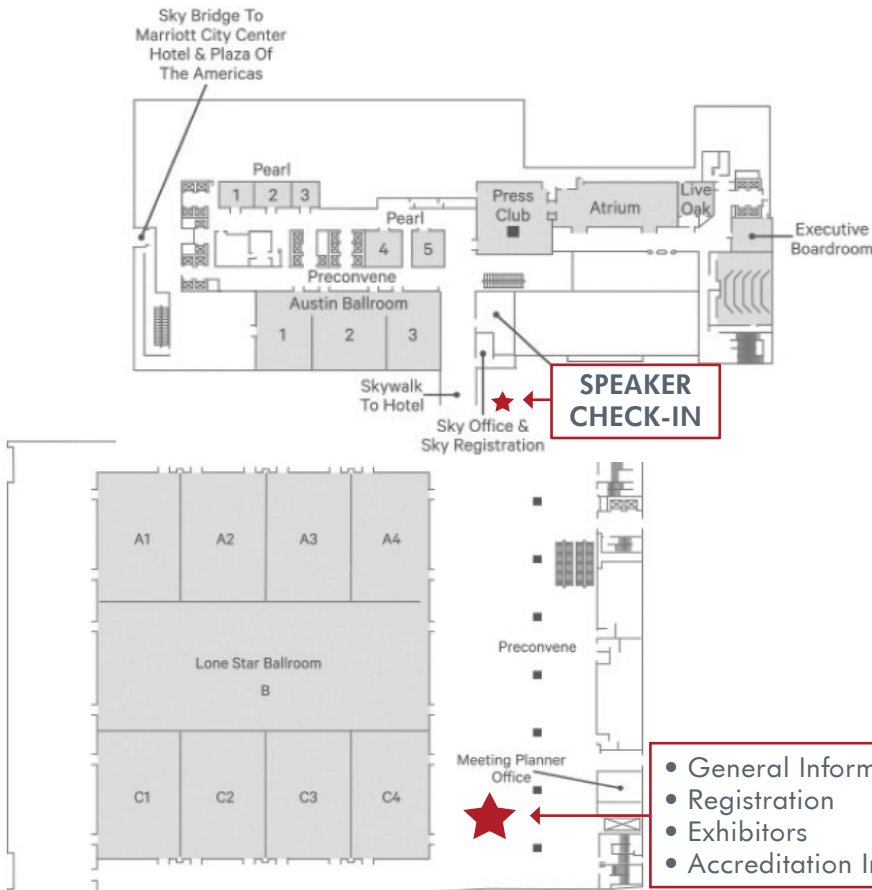

SPEAKER CHECK-IN

- General Information
- Registration
- Exhibitors
- Accreditation Information

3rd FLOOR

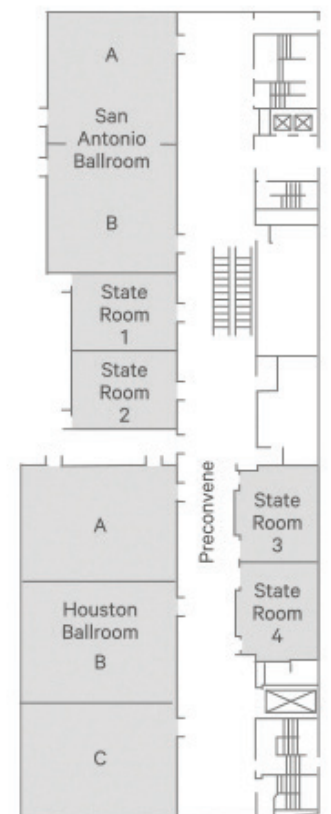

SAVE THE DATE!

20TH ANNUAL



CONFERENCE ON
CRIMES AGAINST WOMEN

JOIN US

MAY 19-22, 2025



STAY UP-TO-DATE ON ALL THE LATEST CCAW HAPPENINGS AT
WWW.CONFERENCECAW.ORG

#nationalccaw #crimesagainstwomen

